

P.C.B. LAYOUT

Electrical:
 Current-max [amps]: 1.0A
 Voltage-max [volts]: 30V
 Withstanding Voltage: 100V AC
 Contact Resistance [ohms]: 50 milliohms max
 Insulation Resistance [ohms]: 100 Megohms min
 Temperature Range: 0° C to +105° C

Material
 Contact: Phorphos Bronze
 Insulator: LCP UL94V-0
 Shell: Brass
 Plating
 Contacts: Gold And Tin Plating
 Shell: Tin Plating

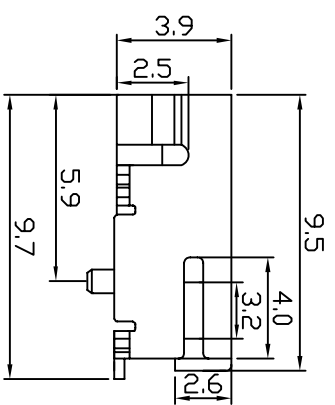
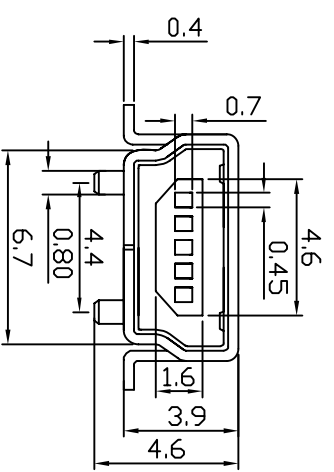

UNITS: mm		CSCONN		SHENZHEN CSCONN PRECISE ELECTRONICS CO.,LTD	
GENERAL TOLERANCE:		PART NO. (INTENDED USE)		TITLE:	
X. ± 5°	0.X ± 0.3	CMI-0805T-B		MINI USB 5P FEMALE SMT	
X.1 ± 2°	0.XX ± 0.2	APPD:		DWG NO.	
XX. ± 1°	0.XXX ± 0.1	CHKD: Skila		MINI USB	
XXX. ± 0.5°		DR: Kitty		SCALE	
				1:1	
				SHEET	
				1 OF 1	
				REV	
				A	

