

A1	A4	A5	A6	A7	A8	A9	A12
GND	VBUS	CC1	D+	D-	SBU1	VBUS	GND
GND	VBUS	SBU1	D-	D+	CC1	VBUS	GND
B12	B9	B8	B7	B6	B5	B4	B1

NOTES:

- 1.) MATERIAL:
 - 1-1. HOUSING: THERMOPLASTIC, UL 94V-0, COLOR: BLACK;
 - 1-2. CONTACT: COPPER ALLOY T=0.12mm;
 - 1-3. SHELL: STAINLESS STEEL T=0.30mm;
 - 1-4. EMC PAD: STAINLESS STEEL T=0.12mm;

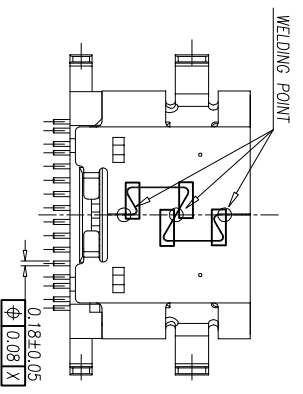
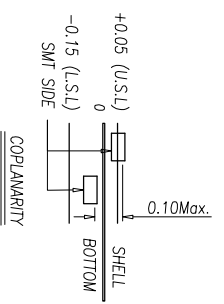
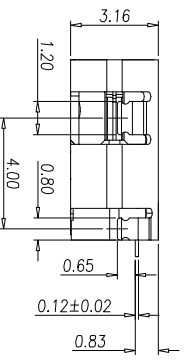
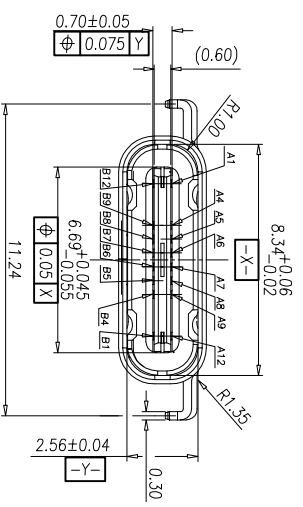

- 2.) FINISH:
 - 2-1. CONTACT: Au 15u" PLATING ON CONTACT AREA, TIN PLATING ON SOLDERTALS, 50u" MIN. NI UNDERPLATING OVERALL;
 - 2-2. SHELL: GOLD FLASH PLATING ON SOLDERTALS, 50u" Min. NI UNDERPLATING;
 - 2-3. EMC PAD: NI PALTED OVER ALL
- 3.) SPECIFICATIONS:
 - 3-1. VOLTAGE RATING: 30V AC/DC
 - 3-2. CURRENT RATING: PIN A4,B4,A9,B9 5A, PIN A1,B1,A12,B12 1.25A, OTHER PIN 0.25A MIN
 - 3-3. INSULATION RESISTANCE: 100MEG.OHM MIN
 - 3-4. CONTACT RESISTANCE: 50 MILL.OHM MAX
 - 3-5. OPERATION TEMPERATURE: -30° TO +85°
 - 3-6. INSERT FORCE: 5-20N
 - 3-7. EXTRACT FORCE: 8-20N
 - 3-8. DURABILITY: 10000 CYCLES

CSCONN

CSCONN PRECISE ELECTRONICS CO.,LTD

PART NO. (INTENDED USE)

TITLE: USB TYPE C FEMALE DIP 沉板2.3MM

APPD:

DWG NO. USB

CHKD: Sk11a

DR: Kitty

UNITS: mm
GENERAL TOLERANCE

X. ±5°
0. X ± 0.25

X. 1 ± 2°
0. XX ± 0.2

XX ± 1°
0. XXX ± 0.1

SCALE: 1:1
SHEET: 1 OF 1
REV: A